

TPW

Pallet truck with integrated scale

USER MANUAL

ENGLISH

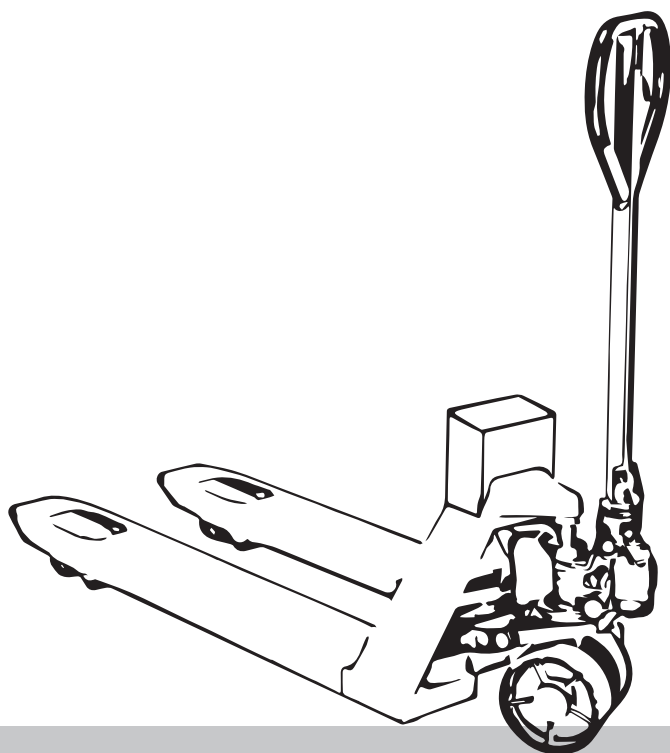

Introduction	5
Safety information - Warnings	5
Technical features	6
Power supply	7
Power supply via battery	7
Power supply via rechargeable battery	7
Battery charge level	7
Tiller/column assembly	8
Truck controls	9
Transport	9
Lifting	9
Discesa	9
Printer	10
Integrated thermal printer	10
Customisable printouts	10
Accessories	11
Swivel column (standard with some models)	11
Usb (depending on model)	11
Antenna (depending on model)	11
Brake	11
Instructions for use	12
Correct weighing procedure	14
Turn on the indicator	14
Put the pallet truck in position	14
Lift the load and read the weight	14
Maintenance warnings	15
Scheduled maintenance	15
Daily maintenance	15
Maintenance	16
Oil level	17

Basic scale functions 18

The display	18
On	19
Off	19
Zero	19
Automatic tare	20
Tare deletion	20
Presettable tare (pt)	21
Print (and reprint of the last ticket)	22
Metrics	22

Additional functions for models with number keypad 23

30-tare log	23
Automatic tare deletion	24
Number IDs	25
Date and time	26
Regulation of the display brightness	26

Advanced scale functions 27

Horizontal totalization	28
Mixing several components	29
Pieces counting	30
Alibi memory	33
Weight check	34
Exchange between net weight and gross weight	36
Percentage weighing	37
High resolution weight display	38
Unit of measurement conversion	38

Metrological information of the scale 39

FAQ - Frequently Asked Questions 40

Print	40
Totalization	40
Tare	40
Weighing	41
Pieces counting	41

Error messages 42

Dear Customer, Thank you for choosing a Dini Argeo product.

The manual weighing pallet truck that you have purchased is ideal for handling and weighing pallets or standardised containers directly where they are located, saving you time and money.

It is equipped with high performance weighing electronics, precise and durable, and features a multifunctional program that can help you perform your daily tasks. Before using the instrument, please read this instructions manual carefully in order to be able to use it in complete safety and to learn about all of the functions it offers.

Safety information - Warnings

The safety precautions illustrated in this manual, marked with  must be observed during all installation, operation, maintenance or repair stages of the weighing system.

Any use other than the one reported in this manual, as well as the failure to follow the safety precautions, shall relieve the manufacturer of any responsibility and void the product warranty.



- Read this manual carefully before carrying out any handling operations or lifting any loads.
- This pallet truck is designed to weigh exclusively on standardised pallets.
- With approved scale, you can perform weighing on EUR-EPAL pallet 800x1200mm (ref. Standards UIC 435-2 and UIC 435-4).
- NEVER load the scale beyond the maximum capacity stated on the plate of the weight readout instrument.
- It is forbidden to use the scale in environments where there is the danger of fire or explosion
- Do not load the forks when they are raised, not even partially.
- Before using the pallet truck ensure it is in perfect working order.
- To achieve a correct weighing result the forks need to be raised at least 5-10 cm in order to avoid the frame from rubbing against anything.
- Do not expose the pallet truck to atmospheric agents (sun, rain, etc.).
- Use the pallet truck in non-condensing environments with moderate temperature and humidity levels
- Use the pallet truck where there are no vibrations.
- Carefully read and apply the aforementioned description of the weight indicator.
- To clean the pallet truck, avoid the use of solvents or aggressive substances.
- It is forbidden to make any modifications to the truck if not authorised by the manufacturer.
- It is forbidden to use the pallet truck when it no longer fulfils the safety criteria.
- It is forbidden to use flammable products to clean the truck.
- Except with specific models, it is forbidden to wash the pallet truck with direct jets of water.
- Do not pour liquids on the indicator.
- Anything not specifically described in this manual is considered improper use of the equipment.

i



- The crossed out wheeie bin symbol on the product shows that it must be brought to appropriate separate waste collection centres at the end of its life cycle or returned to the dealer when purchasing a new equivalent product.
- Proper separate collection to then send the product to recycling contributes to preventing possible negative effects on the environment and to health and promotes recycling. Users who dispose of the product illegally shall face administrative sanctions as provided for by law.

Technical features

Based on the model:

- Painted steel or stainless steel loading forks.
- Standard length 1150 mm or 1280 mm, special sizes on request.
- Width 550 mm or 680 mm, special widths on request.
- Maximum lifting height of the forks: 180 or 200 mm from the ground.
- Height of completely lowered forks: 80 or 85 mm from the ground.
- Polyurethane or non-staining vulkollan or nylon or antistatic rubber steering wheels.
- Double load wheels for greater stability.
- Painted steel load bearing frame.
- 4 aluminium or stainless steel loading cells with IP67 or IP68 protection rating.
- Tiller with multifunction lever.
- Multifunction fixed or adjustable weight indicator.
- Removable rechargeable battery and set-up for 24/7 continuous use kit or battery operation.
- Integrated printer.

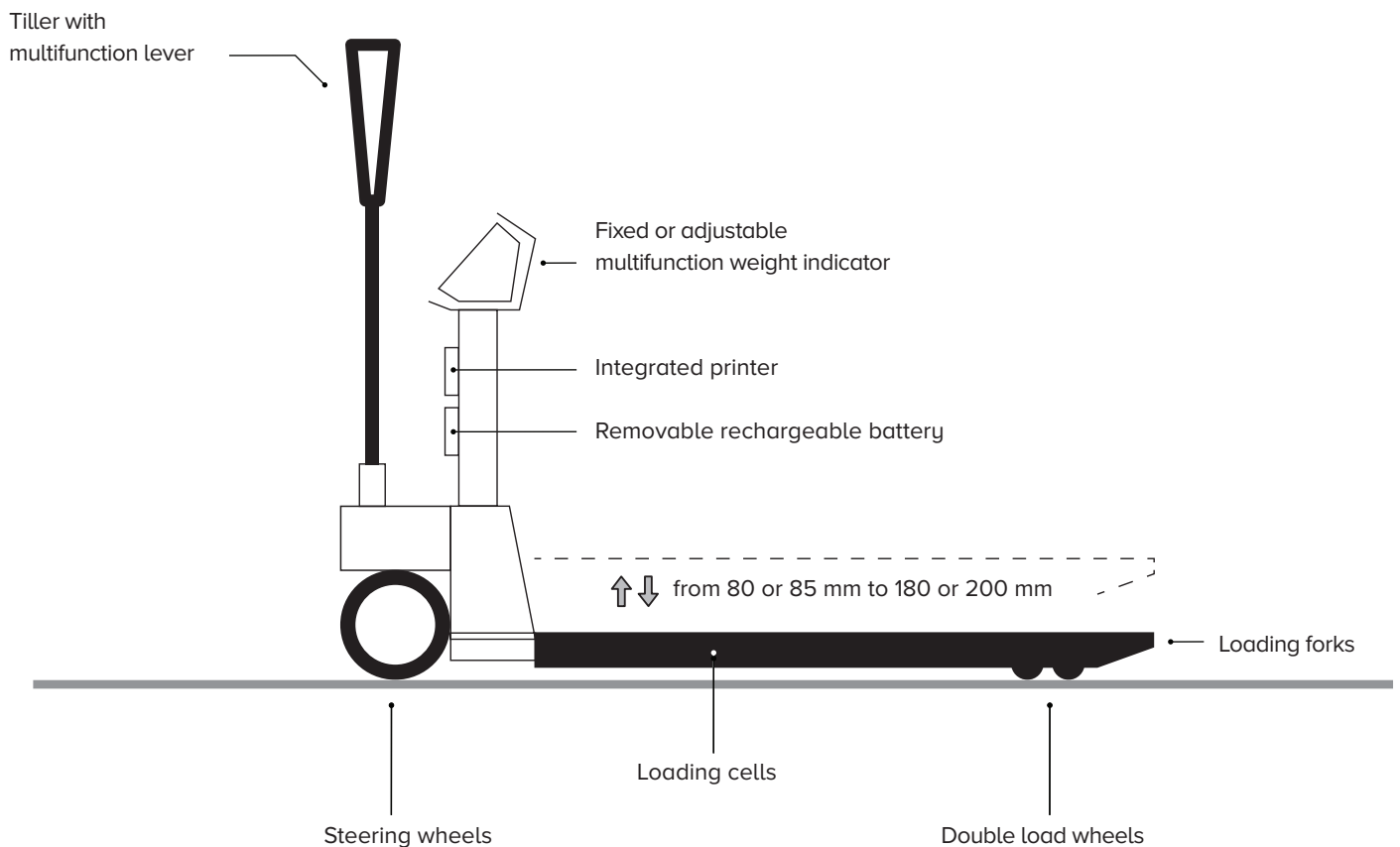

Power supply via battery

If your pallet truck features AA BATTERY power supply, use **4 AA batteries**, either “disposable” or rechargeable.

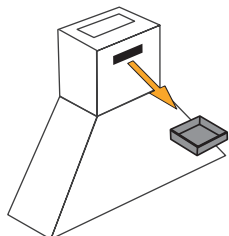

CHANGING THE BATTERIES:

Pull out the front tray and put the batteries in.

ATTENTION: set the batteries up according to the polarity marked inside the tray.

Power supply via rechargeable battery

Depending on what model you purchased, the weighing pallet truck can be equipped with **A** internal rechargeable or **B** removable battery.

BEFORE TURNING THE INSTRUMENT ON FOR THE FIRST TIME, FULLY CHARGE THE BATTERY (APPROX. 12 HOURS)

A INTERNAL RECHARGEABLE BATTERY

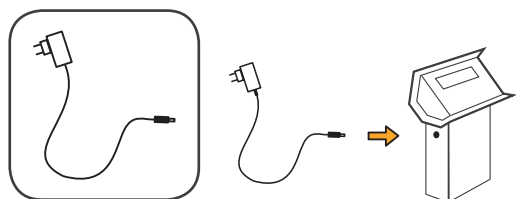

USE ONLY ORIGINAL CHARGER SUPPLIED

B REMOVABLE BATTERY

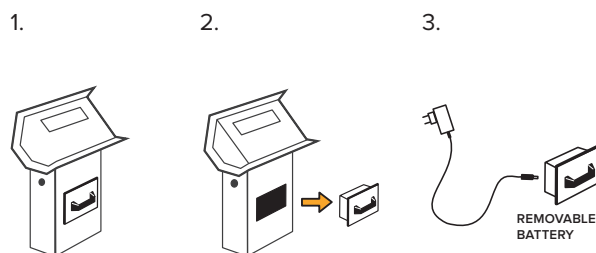

Battery charge level

The dedicated symbol on the instrument display tells you the battery level:



i

- Only use original batteries and battery chargers.
- Under normal conditions of use, we recommend never leaving the battery partially or fully discharged and fully charging it at least once a week.
- In case of prolonged periods of disuse, we recommend removing the battery (in pertaining models) and storing it in a dry place, away from changes in temperature
- Recharge it completely once every 3 months.

A

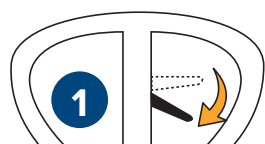

2

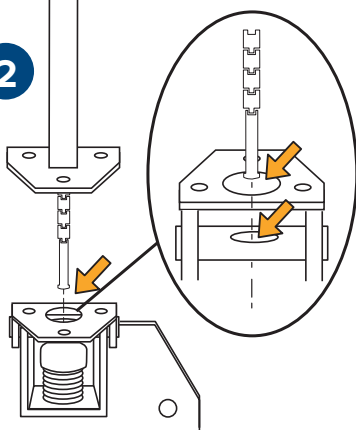

3

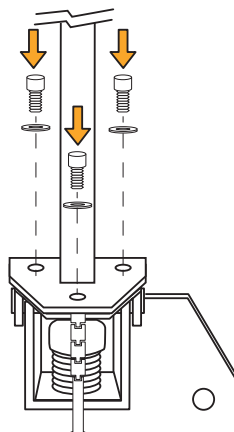

4

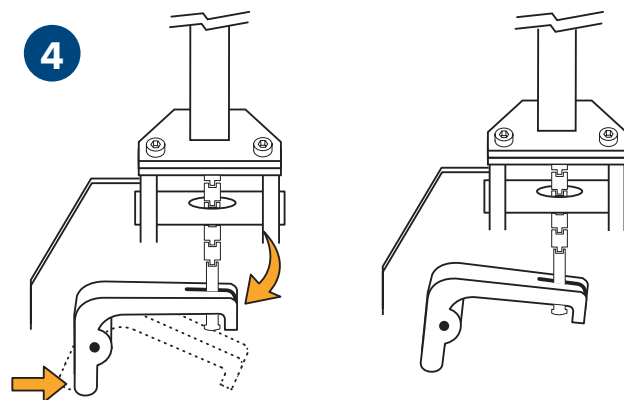

B

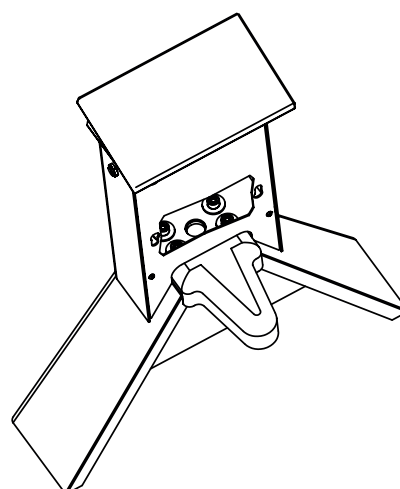
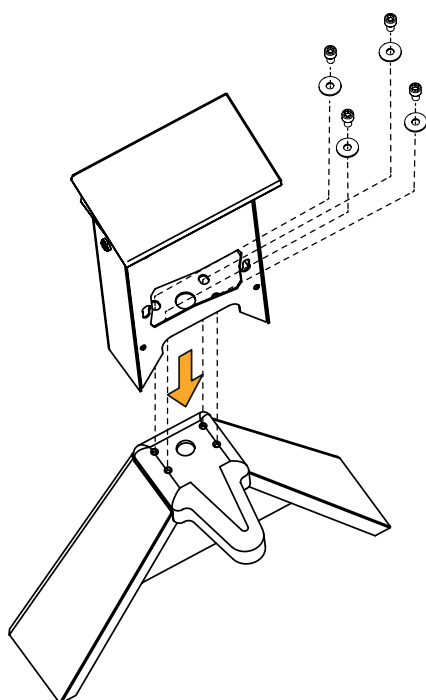

The raised load is moved forwards or backwards by the tiller, which controls the steering wheels.

Transport

POS. 1 > central

The tiller is completely free for transport manoeuvres.

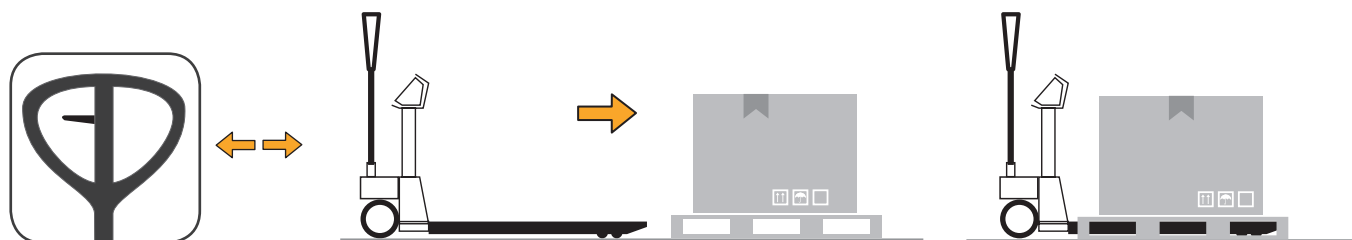

Lifting

POS. 2 > low

Pull the tiller downwards to start up the lifting pump. A return spring places the tiller back in its upright position.

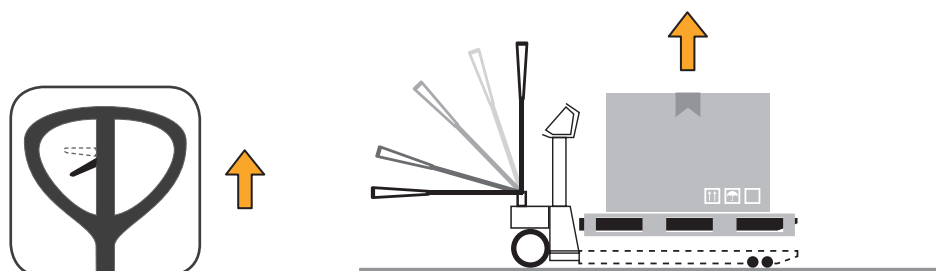

Discesa

POS. 3 > - high

Pull the lever upwards to lower the load. The descent speed is controlled by a special valve that starts up when the lever is firmly pulled to the end of its stroke.



The pallet truck is equipped with a dual-function tiller: traction or manoeuvre and hydraulic lift.

NOTE: raise or lower the truck **ONLY** when stationary.

Integrated thermal printer

The printer is usually in STAND-BY and is only powered by the weight indicator when it is time to print in order to ensure the battery holds it charge longer.

When printing is finished, the printer automatically goes back to STAND-BY.

How to turn the printer on manually

Press ZERO  for 2 seconds

How to replace the roll

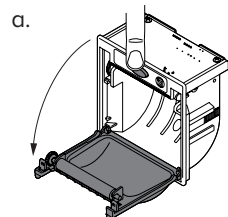

Open the door by pressing the middle button.

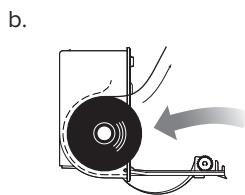

Put the roll in with the thermal side facing outward.

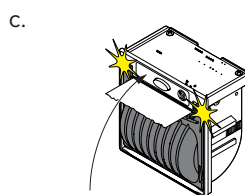

Open the door by pressing both sides.

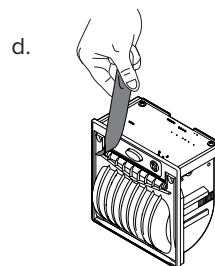

Remove the excess paper.

Customisable printouts

If the instrument is equipped with a printer, the ticket or label can be customised as shown in the following example.

 Customising printouts requires advanced configuration.

Example of ticket/label

MARIO ROSSI SRL		Heading
VIA DELL'INDUSTRIA, 20		
41042 - FIORANO (MO) - ITALY		
WWW.MARIOROSSI.IT		
WEIGH NUM.	1	Progressive weighing ticket (for accumulation modes)
GROSS	15.000 kg	Weight data
TARE	3.000 kg	
NET	12.000 kg	
TICKET NO.	54321	Progressive ticket number
05/08/2015 15:39:03		Date and time
		Bar code 39

Example of packing list

MARIO ROSSI SRL	
VIA DELL'INDUSTRIA, 20	
41042 - FIORANO (MO) - ITALY	
WWW.MARIOROSSI.IT	
WEIGH NUM.	00000001
NET	1.000 kg
WEIGH NUM.	00000002
NET	1.000 kg
WEIGH NUM.	00000003
NET	1.000 kg
WEIGH NUM.	00000004
NET	1.000 kg
TOTAL WEIGHS	00000004
TOTAL NET	4.000 kg
TICKET NO.	12345
09/05/06 15:39:03	

Swivel column (standard with some models)

To ensure maximum display reading comfort.

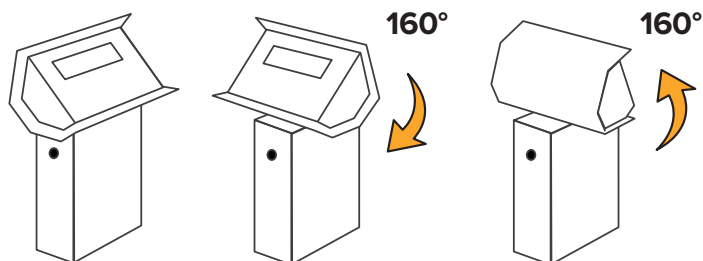

Usb (depending on model)

USB port to store all completed weighing operations on memory stick.

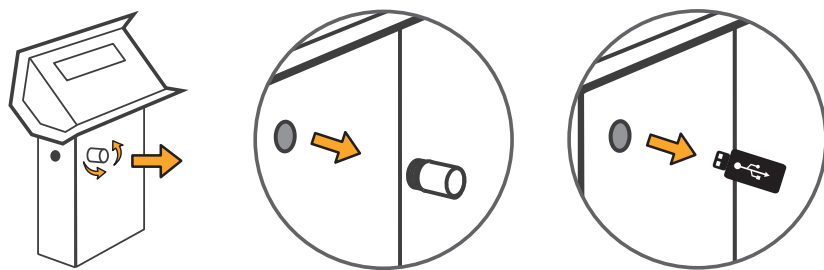

The tiller has an upright return system: be careful during manoeuvring operations.

Antenna (depending on model)

Fixed antenna for wireless data transmission.



Do not rotate or move the antenna, its correct position is vertical.

Brake

Pedal parking brake unit installed on tiller wheels.

ON

OFF

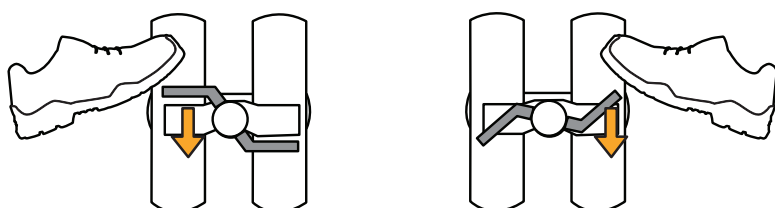

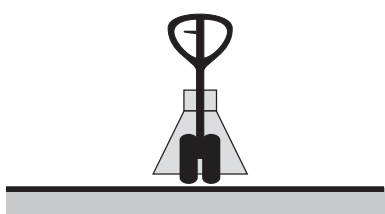
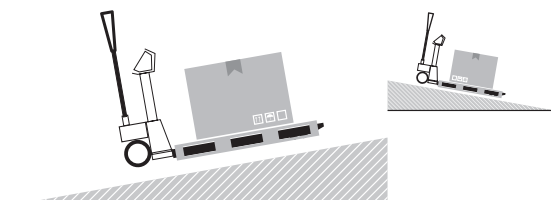
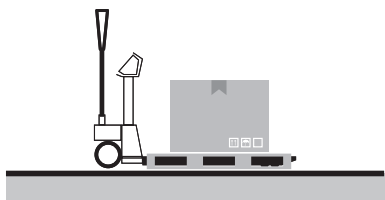

The tiller has an upright return system: be careful during manoeuvring operations.

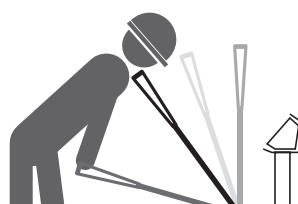

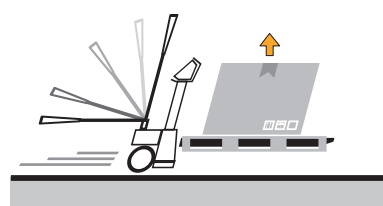
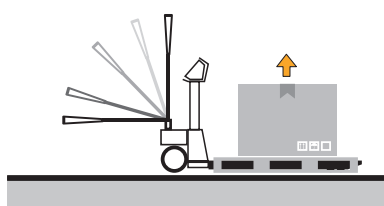
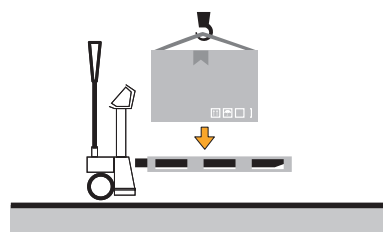
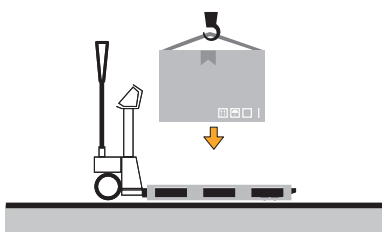
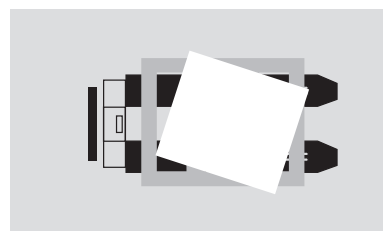
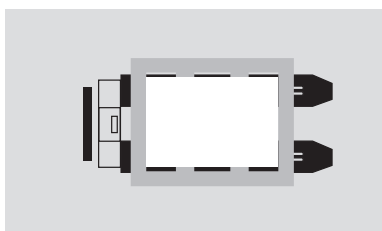
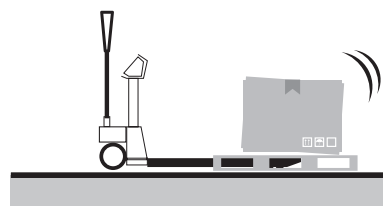
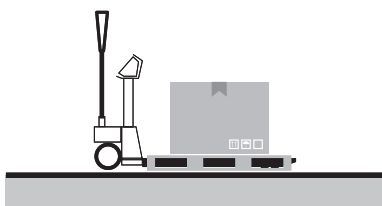

RAISE THE TRUCK ONLY WHEN STATIONARY*

i

*The pallet truck is equipped with a dual-function tiller: traction or manoeuvre and hydraulic lift.

NOTE: raise or lower the truck **ONLY** when stationary.

1 Turn on the indicator

i

Unload the pallet truck scale before turning on.

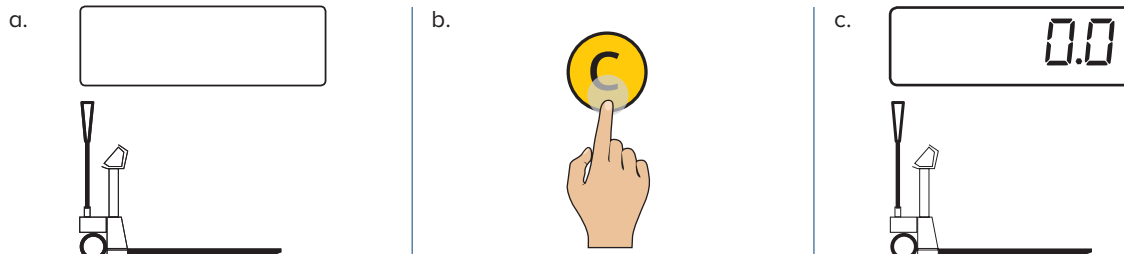

2 Put the pallet truck in position



i

With approved scale, you can perform weighing on EUR EPAL pallet 800x1200mm (ref. Standards UIC 435-2 and UIC 435-4).

3 Lift the load and read the weight

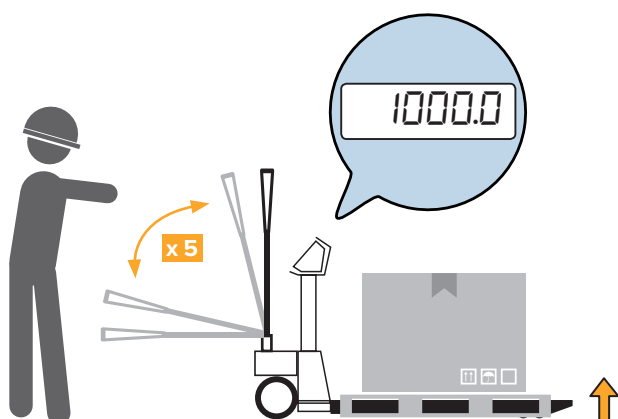

Maintenance warnings

- Before proceeding with the maintenance operation ensure that the truck is in safety mode.
- During maintenance operations do not release work residues into the environment.
- Only perform the maintenance operations described herein, any unspecified procedures can pose a serious risk to untrained operators and in any case alter the machine's degree of safety.
- Always and only use original spare parts.
- During operation or maintenance, plates and stickers must NOT be removed, hidden, or made illegible.
- More complex maintenance and/or repairs must be carried out by skilled staff.

Scheduled maintenance



Note that before starting maintenance operations you have to place the truck on a solid surface.

- Ensure that the pallet truck rollers are not obstructed by dirt
- Periodically grease the bearings of the rollers and wheels
- Grease the tiller control lever guide
- Approximately every six months, check the oil level and top up with hydraulic oil IP46 if necessary. For topping up refer to the "OIL LEVEL" paragraph. N.B. When performing complete spent hydraulic oil changes, it must be disposed of in accordance with the regulations in force.
- Replace wheels and rollers when they are worn.
- In any case, for minor repairs and solutions, contact your AUTHORISED TECHNICAL ASSISTANCE

Daily maintenance



Daily truck maintenance is the responsibility of the worker appointed as pallet truck operator.

BELOW ARE THE CHECKS TO BE CARRIED OUT TO ENSURE OPTIMAL WEIGHING AND HANDLING PERFORMANCE:

- Roller and wheel integrity check
- Visual check of the state of the truck frame
- Weight indicator operation check
- Integrated printer operation check (where applicable)
- Pump operation check

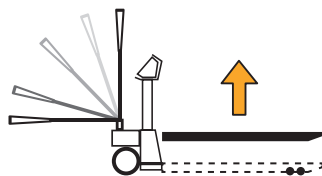
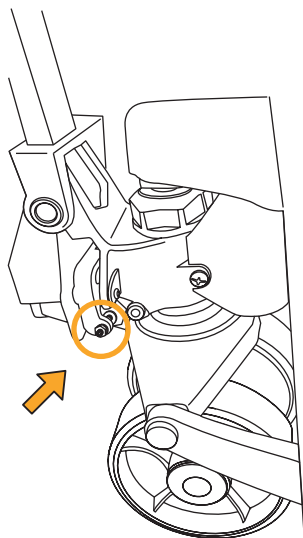

a. Place the forks at the maximum height.

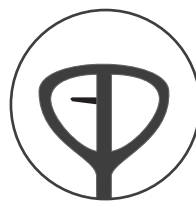

b. Place the tiller control lever in POS. 1 (centre).

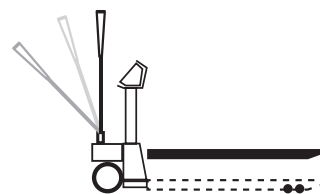

c. Make sure the tiller is in the upright position.

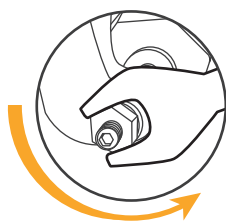

d. Unscrew the locknut, to unlock the adjustment screw.

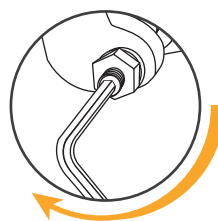

e. Slowly turn the adjustment screw clockwise until the forks start moving downwards.

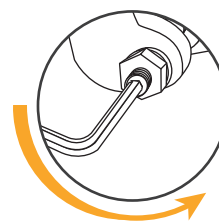

f. As soon as the forks start lowering, turn the adjustment screw one and a half turns anti-clockwise.

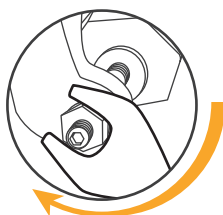

g. Tighten the locknut, to lock the adjustment screw.

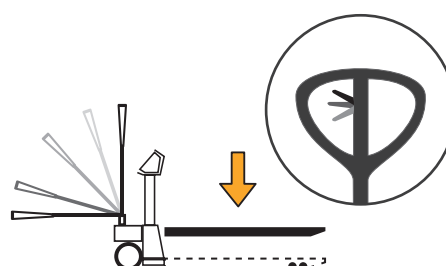

h. Using the control lever, the downwards movement can be carried out from any tiller position.



Make sure that with the tiller in its transport position, it is not possible to raise the forks. Otherwise you will need to:

- unlock the lock nut,
- turn it half a turn clockwise,
- tighten the locknut back up again.

Oil level



Check the oil level **EVERY 6 MONTHS**.
Only use hydraulic oil, not motor or brake oil.



OIL VISCOSITY
30 CST A, 40°C
TOTAL VOLUME
0,3 LT

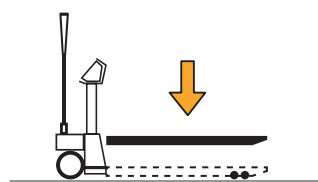
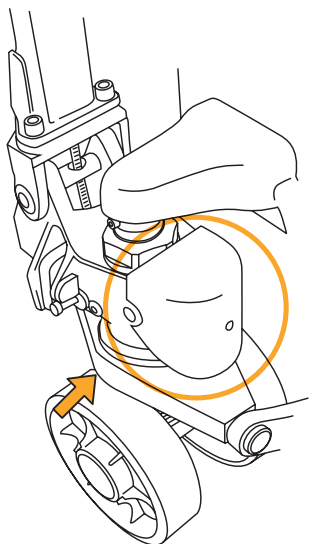

a. Lower the forks all the way.

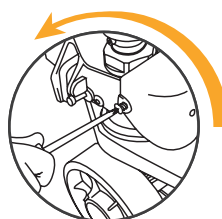

b. Remove the protective casing, the seal and the cap.

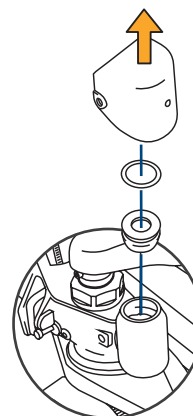

c. If necessary, add up to 20 mm from the top edge of the tank.

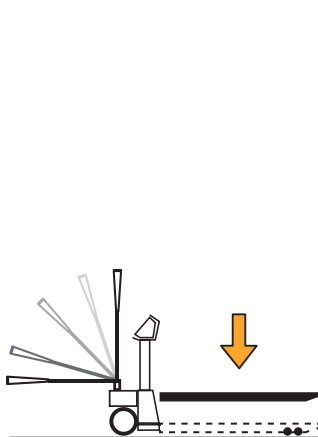
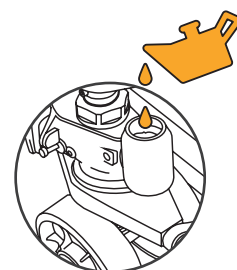

d. Operate the pump several times to release any air from the hydraulic circuit, then lower the forks completely.

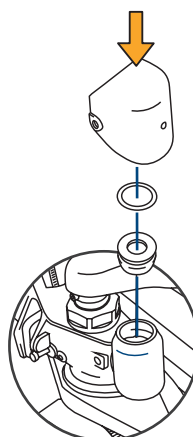

e. Put the cap, the seal and the protective casing back on.

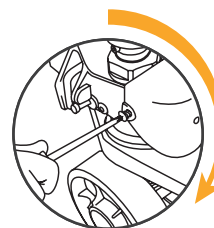

The display

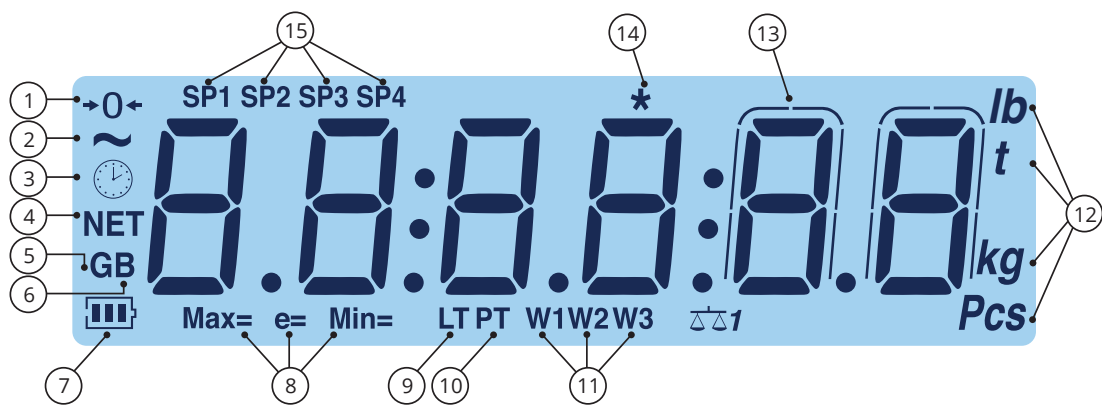

Number	Symbol	Description
(1)	→0←	The scale is unloaded and at zero (gross).
(2)	~	The weight is unstable.
(3)		The time is being shown on the display.
(4)	NET	The weight displayed is net. There is a saved tare.
(5,6)	G B	The weight displayed is gross.
(7)		Battery level.
(8)	Max=Min= e=	Metrics are being displayed.
(9)	LT	A locked tare is active.
(10)	PT	A manual tare is active.
(11)	W1 W2 W3	Indicate the range of active weighing.
(12)	lb ... Pcs	Units of measurement - Pounds (lb), tonnes (t), kilograms (kg), grams (g), number of pieces (Pcs).
(13)		The weight is being displayed in high resolution.
(14)	*	This means a key is pressed. In some operating modes, it means that a specific function is active.
(15)	SP1...SP4	These indicate the active relay ports (only with the optional board).

LETTERS:

A	B	C	D	E	F	G	H	I	J	K	L	M	N	O	P	Q	R	S	T	U	V	W	X	Y	Z
<i>A</i>	<i>B</i>	<i>C</i>	<i>D</i>	<i>E</i>	<i>F</i>	<i>G</i>	<i>H</i>	<i>I</i>	<i>J</i>	<i>K</i>	<i>L</i>	<i>M</i>	<i>N</i>	<i>O</i>	<i>P</i>	<i>Q</i>	<i>R</i>	<i>S</i>	<i>T</i>	<i>U</i>	<i>V</i>	<i>W</i>	<i>X</i>	<i>Y</i>	<i>Z</i>

NUMBERS:

0	1	2	3	4	5	6	7	8	9
<i>0</i>	<i>1</i>	<i>2</i>	<i>3</i>	<i>4</i>	<i>5</i>	<i>6</i>	<i>7</i>	<i>8</i>	<i>9</i>

On

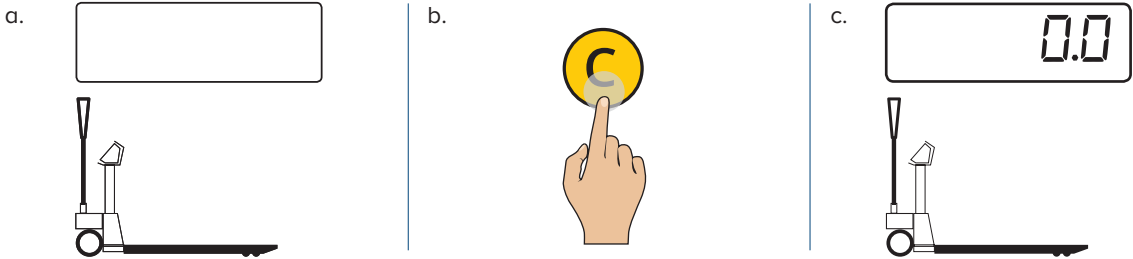

Off

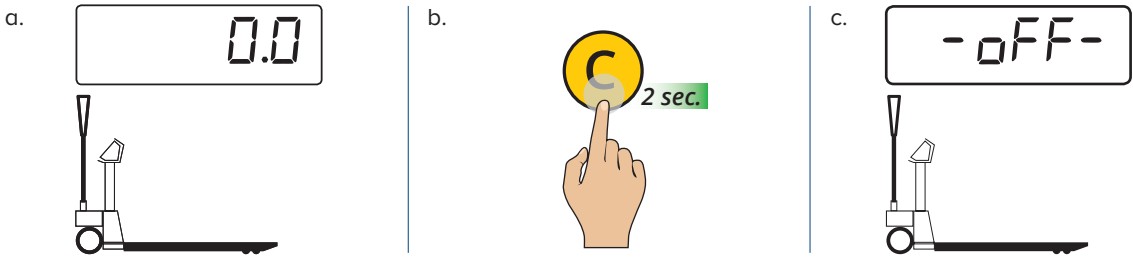

Zero

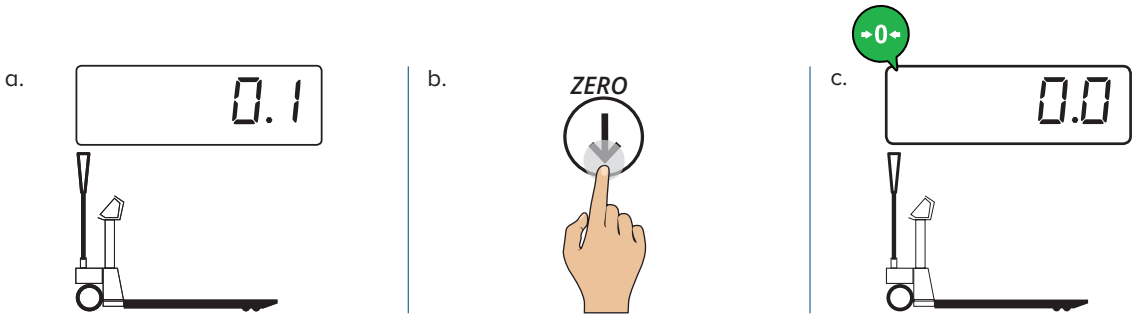

Automatic tare

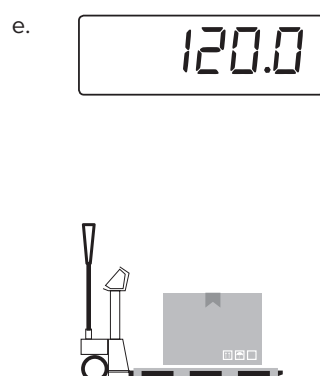
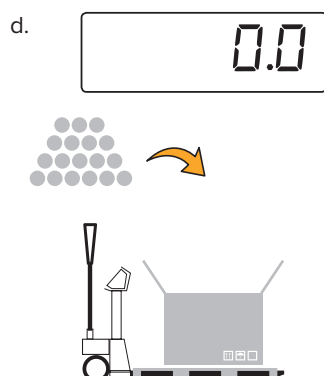
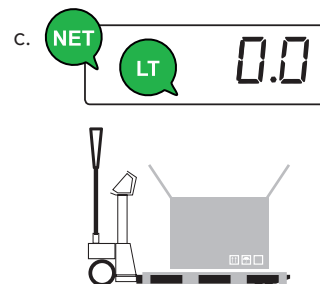
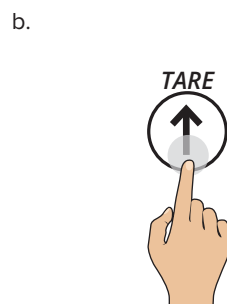
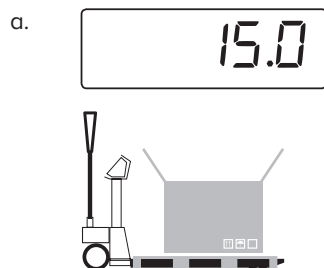
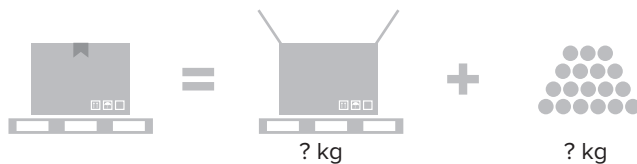

Tare deletion

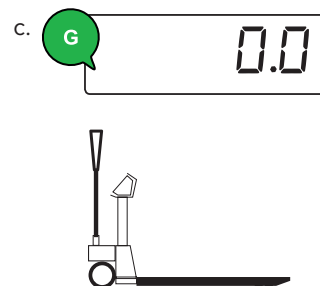
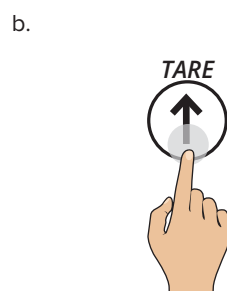
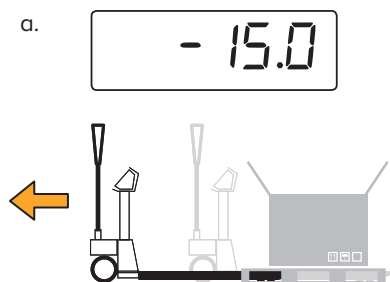

Presettable tare (pt)

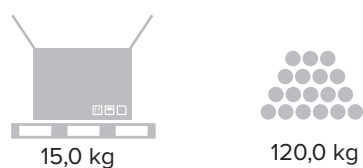
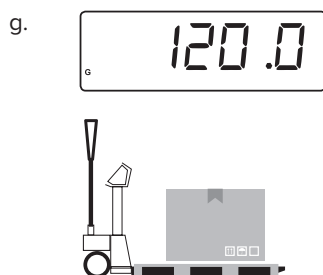
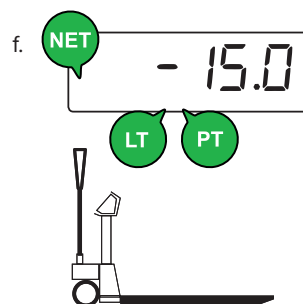
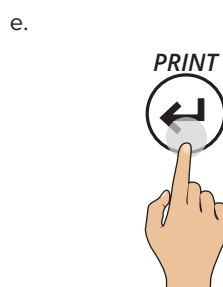
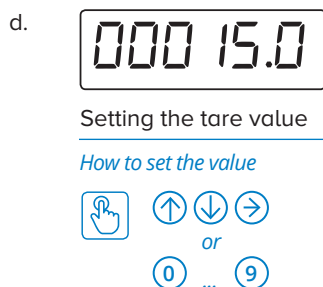
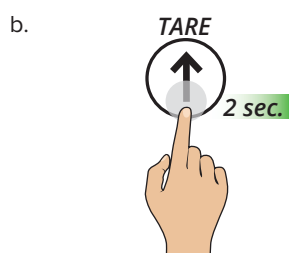
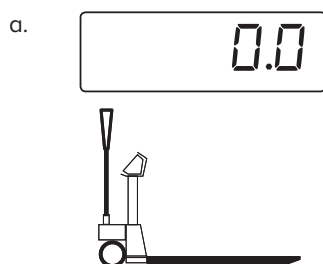

i

If the pallet truck has a number keypad, it is possible to enter the tare quickly:

a. Enter the tare value

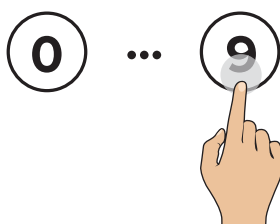

b.



Print (and reprint of the last ticket)

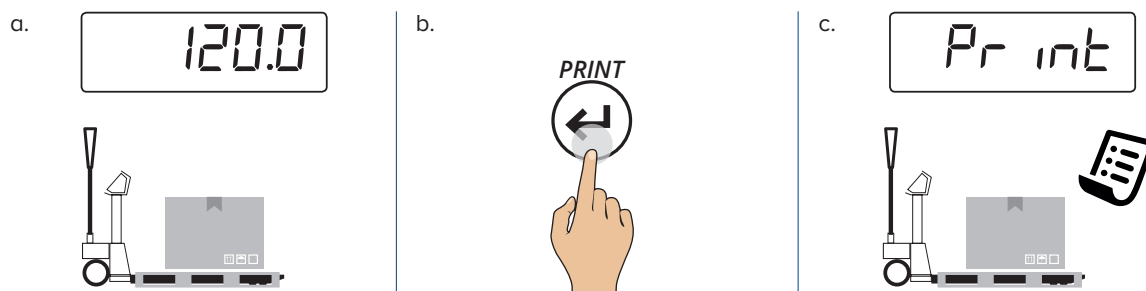

To reprint the last ticket

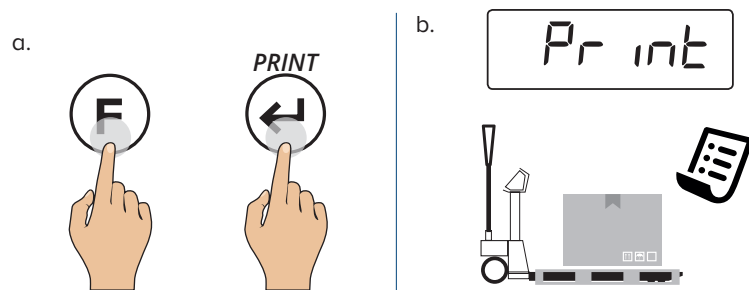

Metrics

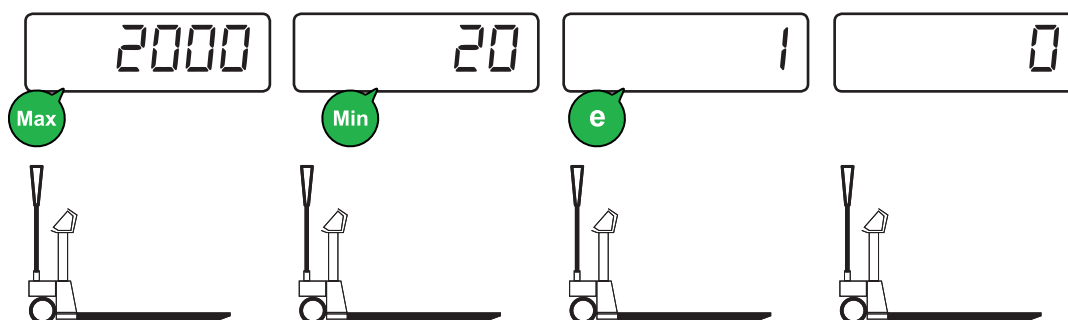
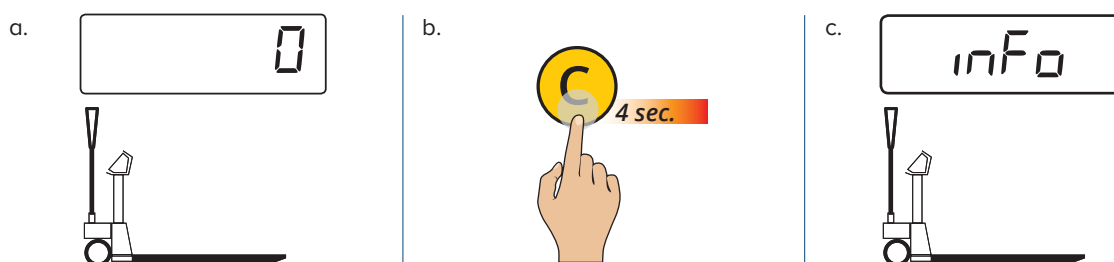

30-tare log

This memorises the most commonly used tares (up to 30), to simplify retrieval with quick selection.

Example

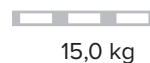

How to store a tare

a.

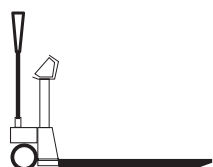

b.

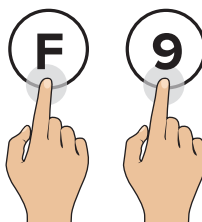

c.

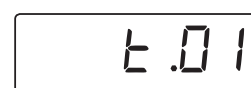

Select the memory.



d.



e.



Enter the tare value



f.



How to retrieve a stored tare

a.

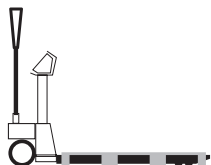
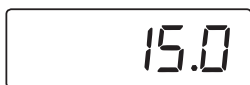

b.

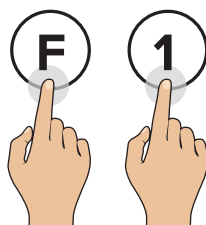

c.

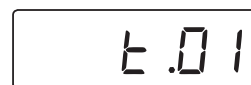

Select the memory.

How to set the value



d.

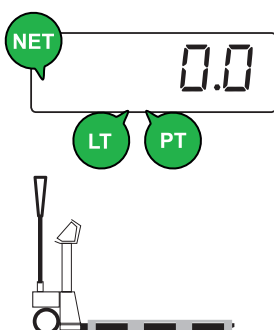

Automatic tare deletion

a.

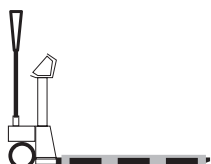

b.

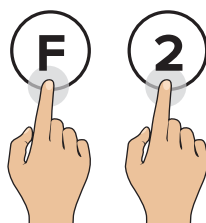

c.

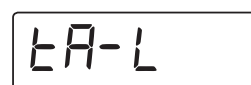

Automatic deletion disabled

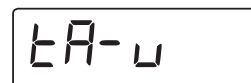

Automatic deletion enabled: the tare will be deleted automatically when the pallet truck is completely unloaded.

Number IDs

The instrument is fitted with two memories for the temporary registration of numerical codes that can be used to identify the product, the operator, the lot etc... These codes, if entered, will be present in the ticket when printing.

How to enter the ID

a.

b.

c.

Select the memory.

How to set the value

① or ②

d.

e.

Enter the required ID
(up to 10 digits)

How to set the value

or

① ... ⑨

f.

How to enable automatic ID deletion

a.

b.

c.

Select the memory.

How to set the value

① or ②

d.

e.

Automatic deletion disabled.

Automatic deletion enabled: the entered ID will be deleted automatically when the pallet truck is completely unloaded.



The numerical IDs zero automatically when turning off the scale.

Date and time

a.



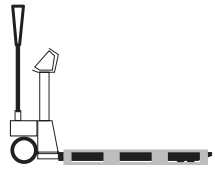

b.



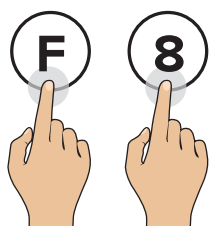

c.

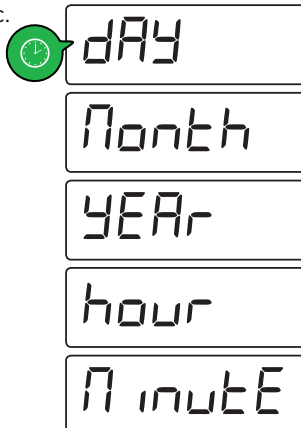



i

Only if the option date and hour is present.

Regulation of the display brightness

a.





b.

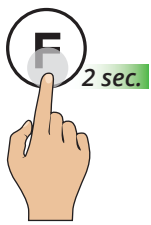

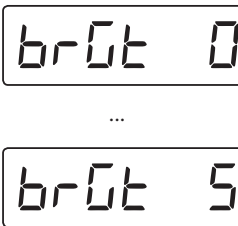

c.



Set the brightness

How to set the value

The scale features the following modes of operation

Horizontal totalization

Mixing several components

Pieces counting

Alibi memory

Weight check

Exchange between net weight and gross weight

Percentage weighing

High resolution weight display

Unit of measurement conversion



Enabling operating modes requires advanced configuration.



Horizontal totalization

How to sum the weights

a.

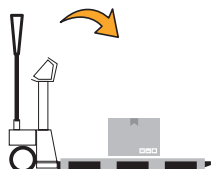

b.

c.

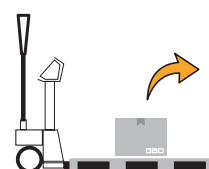

d.

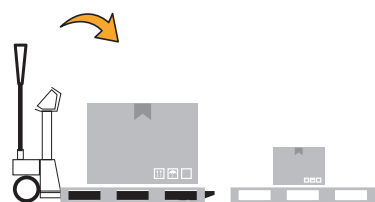

e.

f.

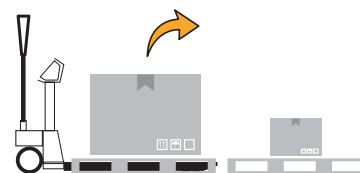

g.



h.

i.



How to read, print and reset the total

a.

b.

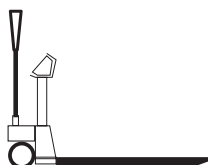

Number of weighs

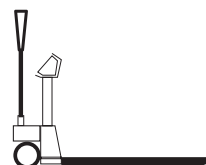

Total weight



i

With number keyboard, the combination of **(F)** keys + **(7)** displays the current total without printing it/resetting it.





Mixing several components

How to sum the weighs

<p>a.</p>	<p>b.</p>	<p>c.</p>
<p>d.</p>	<p>e.</p>	<p>f.</p>
<p>g.</p>	<p>h.</p>	<p>i.</p>

How to read, print and reset the total

<p>a.</p>	<p>b.</p> <div style="display: flex; align-items: center;"> <div style="text-align: center;"> <p>Number of weighs</p> </div> <div style="margin: 0 10px;">...</div> <div style="text-align: center;"> <p>Total weight</p> </div> </div>
-----------	---

i

With number keyboard, the combination of **(F)** keys + **(7)** displays the current total without printing it/resetting it.



Pieces counting

How to sample and count

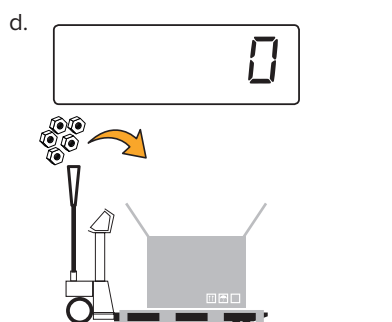
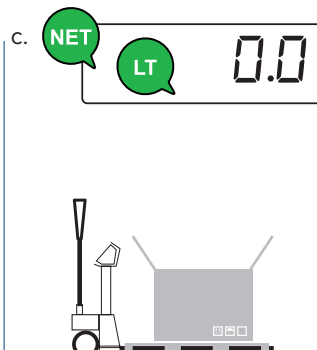
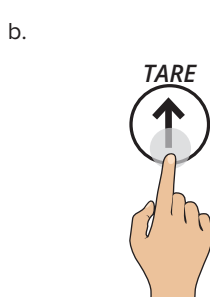
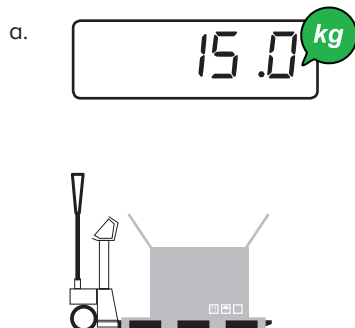

Load the desired reference quantity (e.g. 5 pieces).
For a correct sampling, the reference quantity must have a weight of at least 0.1% of the maximum scale capacity.

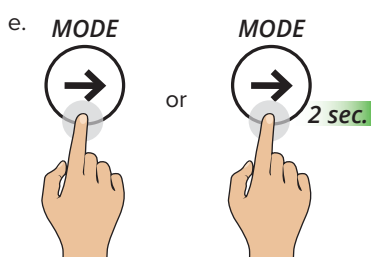

*If the pallet truck scale is already in counting mode (active sampling), in order to sample again press the key for 2 seconds. With the numerical keyboard, the combination of the (F) + (5) keys allows to type the desired quantity (in any amount).

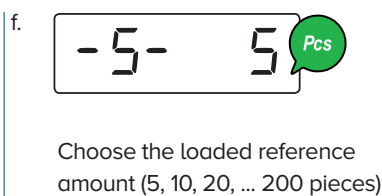

Choose the loaded reference amount (5, 10, 20, ... 200 pieces)

How to set the value

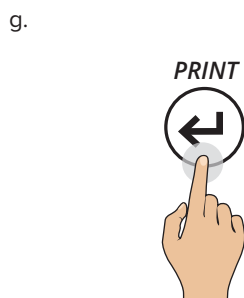

Sampling, please wait...

*With the numerical keyboard, the combination of the (F) + (7) keys allows to modify the sampling time. The more the time, the more the sampling precision.

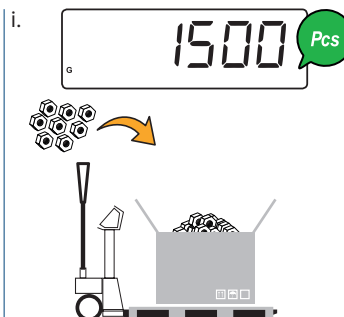



How to switch from piece to weight display and vice versa

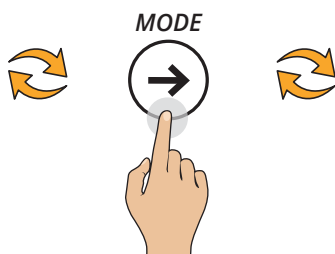

You can go from counting to weighing at any time



How to enter the average unit weight (PMU)

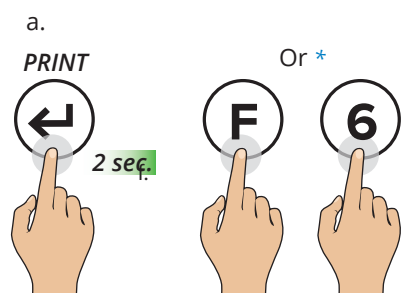

* With the numerical keyboard, it is possible to use the rapid combination

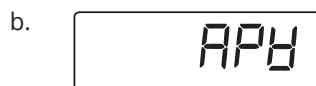

Enter the average unit weight

e.g. = = 10,3427g

How to set the value

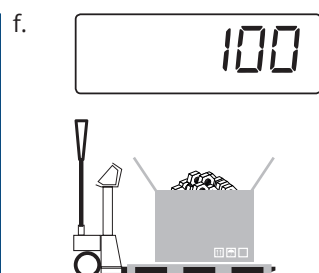
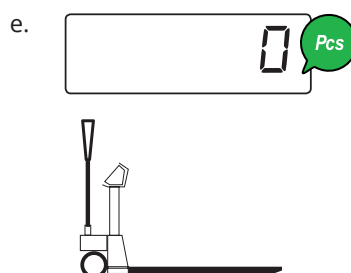
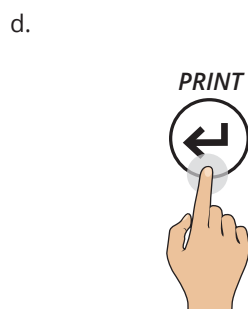

For correct counting, you must set the known tare value (see page 21) or tare the empty container and fill it with the pieces to count.



Total load count

a. Run a tare of the overall load



b. Pick up the sampling pieces (5, 10, 20, 30, 40, 50, 60, 75, 100, 200 pieces).

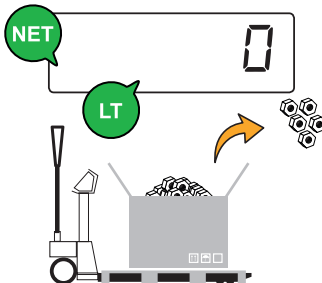

c.

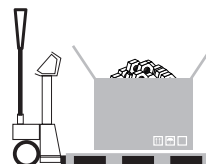
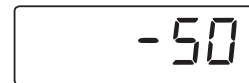

d.

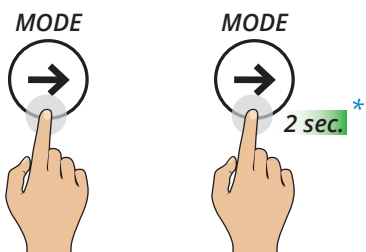

** If the pallet truck is already in count mode (sampling enabled), press the MODE button for two seconds for re-sampling.*

e.



Select the desired reference quantity (5, 10, 20, ... 200 pieces)

How to set the value



Using the number keyboard, pressing F (or Fn) + 5 allows you to type in any amount.

f.



g.

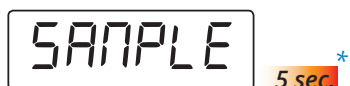

Sampling, please wait...

** With the numerical keyboard, the combination of the (F) + (7) keys allows to modify the sampling time. The more the time, the more the sampling precision.*

h.

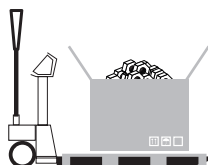

i. Load the selected reference quantity

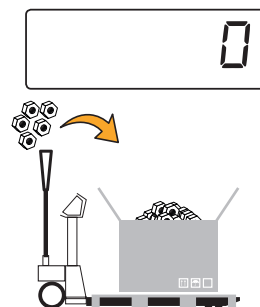

j. Delete the temporary tare



k. Manually set the tare value (pallet + container)



l.

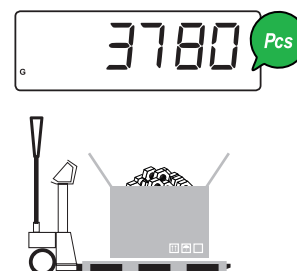



Alibi memory

How to record a weighing operation in the alibi memory

-
-
- Saving a weighing operation in alibi memory.

Alibi memory reading

-
-
- Enter the re-write number
- How to set the value
-
- Enter the weighing operation identification number
- How to set the value
-
- | | |
|-------|-----------------|
| Ch 1 | Reading channel |
| UN AG | Unit of measure |
| Gross | Gross weight |
| tArE | Tare |



Only if the optional card is present.





Weight check

How to start the check with known reference weight

a.



b.

c.

d.

How to set the value

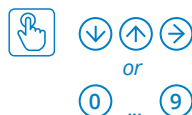

e.

f.
Enter the lower tolerance

g.

How to set the value

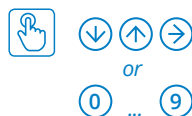

h.

i.
Enter the higher tolerance

j.

How to set the value

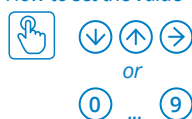

k.

l.
Enter the minimum weight above which the control is triggered



m.



How to set the value



n.



o.

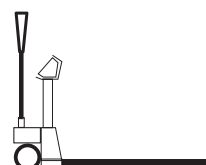

Example 1

To check a weight of 1000 kg with +/- 5 kg tolerance (that is, between 995 kg and 1005 kg), set:

tarGet = 1000.0

t.in = 5.0

t.out = 5.0

Example 2

To check a weight of 500 kg with +10 kg / - 20 kg tolerance (that is, between 480 kg and 510 kg), set:

tarGet = 500.0

t.in = 20.0

t.out = 10.0

How to check the weight

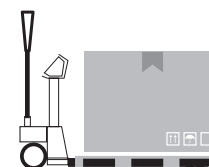
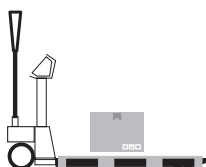
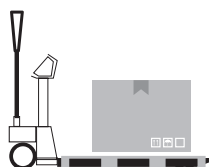



Exchange between net weight and gross weight

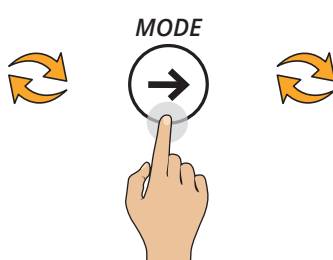
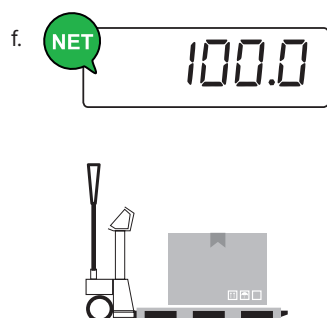
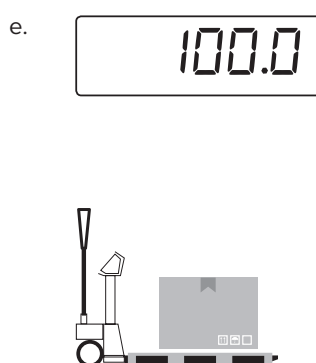
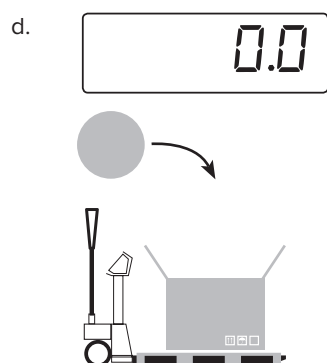
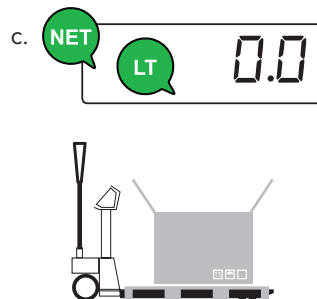
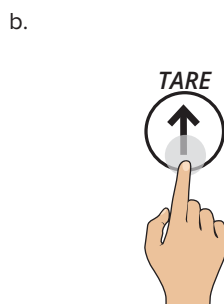
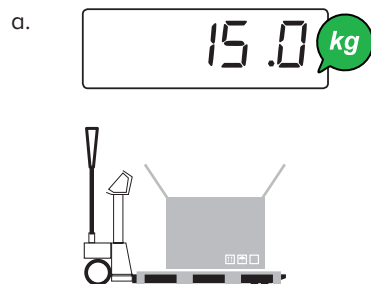

You can go from net weight to gross weight at any time.

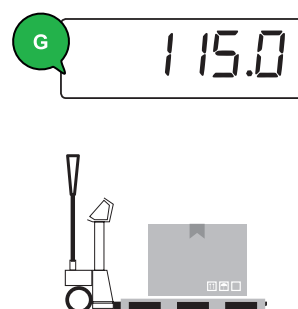



Percentage weighing

Percentage check

I. How to set the reference percentage

a.

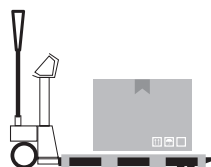
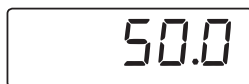

b.



c.

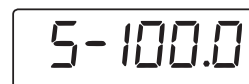

How to set the value



d.



e.

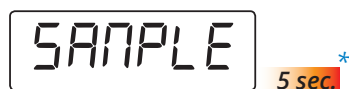

Sampling, please wait...

* With the numerical keyboard, the combination of the **(F) + (7)** keys allows to modify the sampling time. The more the time, the more the sampling precision.

f.

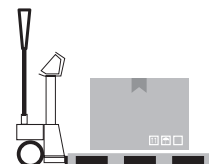

g.

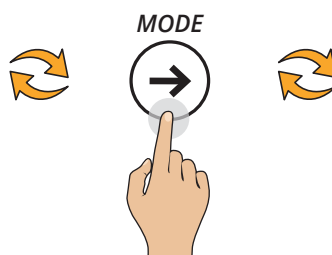
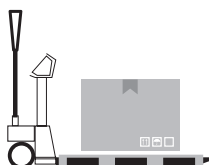

You can switch from the % display to the weight display at any time.

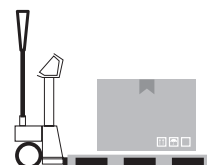

High resolution weight display

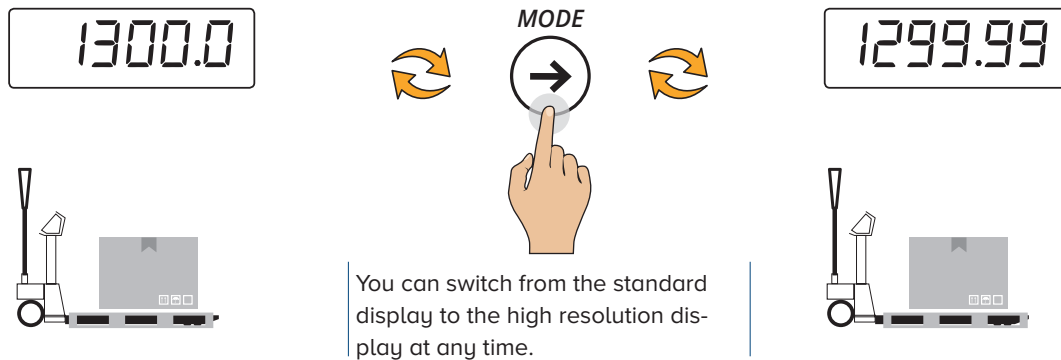

i

If the pallet truck is approved for use in relation to third parties, the high resolution display lasts for 5 seconds, and is then disabled automatically.

Unit of measurement conversion



How to convert the unit of measurement into pounds (standard mode)

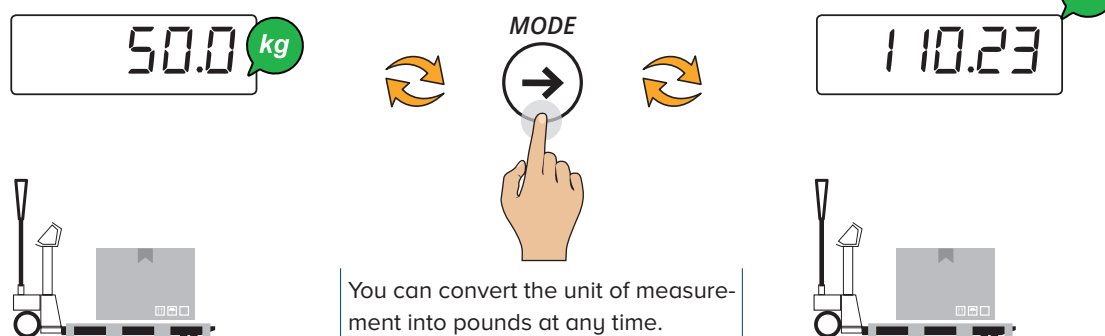

Identification of the metrological software

1. Turn off the scale

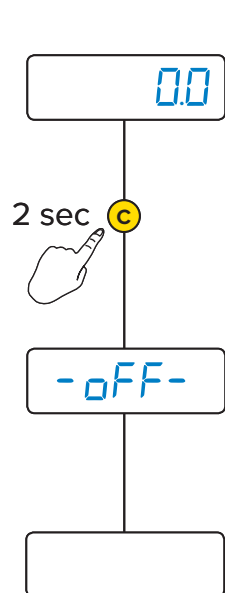

2. Follow the procedure:

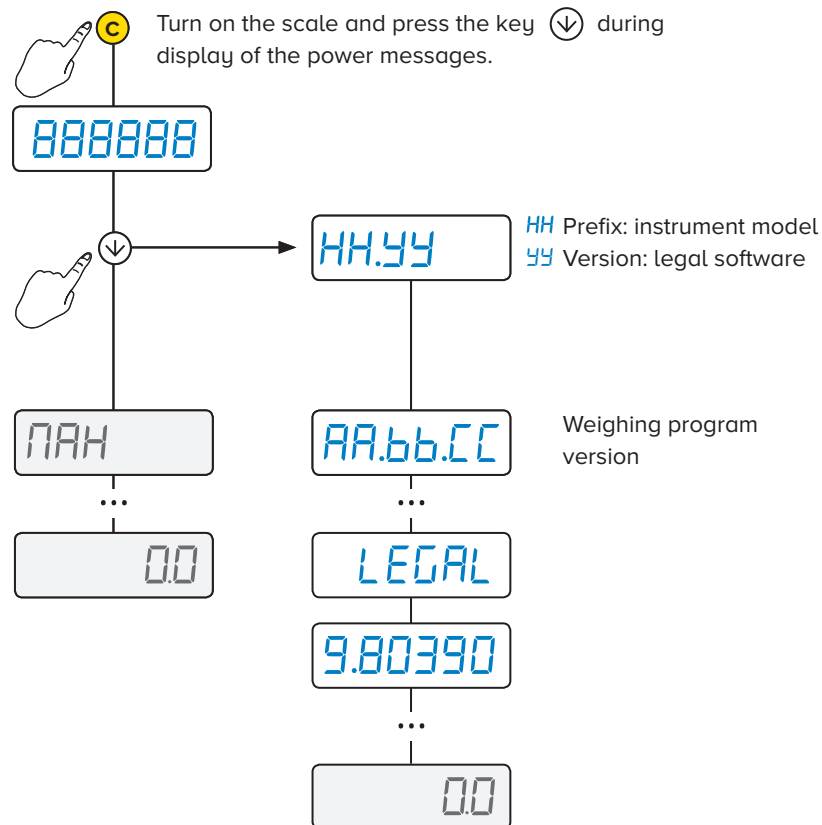

Print

The scale does not print

- Another printout is already in progress (b_u5_Y)
- Make sure there is a roll in the printer
- The printer does not switch on
- The weight is unstable (u_n5tPb)
- The net or gross weight is negative or insufficient for printing (Lob)
- Underload or overload (____ or -____) (u_n.oUEr)
- The scale was not unloaded after the last printing (no.0.u_n5)
- You are trying to print a non-approved weight

Totalization

The scale does not accumulate

- Make sure there is a roll in the printer
- The printer does not switch on
- The weight is unstable (ун5тAb)
- The net or gross weight is negative (Lob)
- Underload or overload (_____ or _____) (ун.обУEr)
- The scale was not unloaded after the last printing (но.0.ун5)
- The weight is too low for the weighing operation (Lob)
 - less than 10 divisions for the accumulator modes
 - less than "Min" for the approved products (shown on the measuring plate)

The sale has lost the total

- Switching off the scale causes the accumulated totals to be lost

Tare

The scale does not tare

- The weight is unstable (unStAb)
- The gross weight is negative (LoH)
- The weight is insufficient
- The weight exceeds the maximum capacity
- The tare function has been deactivated
- In the event of manual tare, the value exceeds the maximum capacity

Weighing

The scale does not switch on

- Make sure the power cable is connected properly
- Connect the battery charger and try again. If the instrument continues to malfunction, contact the dealer.

The scale switches off suddenly

- Automatic switching off active
- Low battery
- Battery failure
- Power supply line failure

The scale is not reactive

- One of the available energy saving modes has been activated
- An unsuitable weighing filter has been selected

The scale display switches off and displays a dot

- Stand-by mode is active: press a key to reactivate weighing.
- Energy saving mode is active: contact the dealer for further details.

The scale displays a permanent "Zero" message

- The scale is unable to automatically reset the weight because it exceeds the maximum resettable weight at switch-on.
- Unload the scale and try again. If the scale continues to have the same problem even when there is nothing on it, contact the dealer.

The weight is unstable

- Check whether the weighing filter is active.
- If the support surface is subjected to vibrations from machinery or moving vehicles, move the scale onto another surface and try again.

Pieces counting

The scale does not carry out sampling

- The weight is unstable (*Error not*)
- The weight is insufficient, add more pieces and try again (*Error*)

MESSAGE	DESCRIPTION	SOLUTION
<i>buSy</i>	Another printout is already in progress	Wait for the printout in progress to be finished and try again.
<i>unStAb</i>	The weight is unstable	Check the weighing filter. If the support surface is subjected to vibrations from machinery or moving vehicles, move the scale onto another surface and try again.
<i>LoH</i>	Net or gross weight is negative or insufficient for printing	Add weight and try again.
<i>un.oUEr</i>	Underload or overload (_____o_____)	Completely unload the scale, making sure Δ lights up. Load the weight on again and try again.
<i>no.O.unS</i>	The scale was not unloaded after the last printing	Completely unload the scale, making sure Δ lights up. Load the weight on again and try again.
<i>Err.NoSt</i>	The weight is unstable	Wait for stability (the \sim light) and try again.
<i>Error</i>	In pieces counting mode, the weight is insufficient for proper sampling.	Add more pieces and try again.
<i>t iLt</i>	Angle error.	Move the pallet truck to a flat surface and try again.

This publication, or portions thereof, may not be duplicated without written permission from the Manufacturer. All information contained in this manual is based on the data available at the time of its publication; the Manufacturer reserves the right to make changes to its products at any time without notice and without incurring any penalty. We therefore recommend that you always check for any updates.

The individual in charge of pallet truck operation must ensure that all safety regulations in force in the country of use are applied, ensuring that the appliance is used in accordance with the purpose it is intended for and to avoid any danger for the user.

The Manufacturer declines any liability arising from any weighing operation errors.

**HEAD OFFICE**

Via Della Fisica, 20
41042 Spezzano di Fiorano, Modena - Italy
Tel. +39.0536 843418 - Fax. +39.0536 843521
info@diniargeo.com

SERVICE ASSISTANCE

Via Dell'Elettronica, 15
41042 Spezzano di Fiorano, Modena - Italy
Tel. +39.0536 921784 - Fax. +39.0536 926654
service@diniargeo.com